



**TRAILMATE**

[www.trailmate.com](http://www.trailmate.com)

# DOUBLE JOYRIDER



# OWNER'S MANUAL

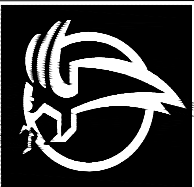

Trailmate

DOUBLE JOY RIDER ILLUSTRATED PARTS BREAKDOWN

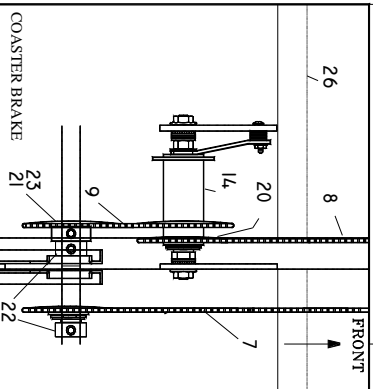
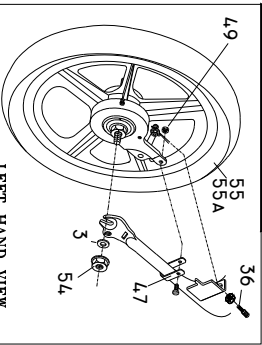
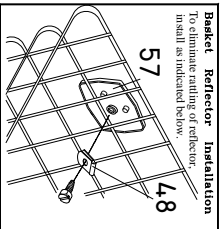
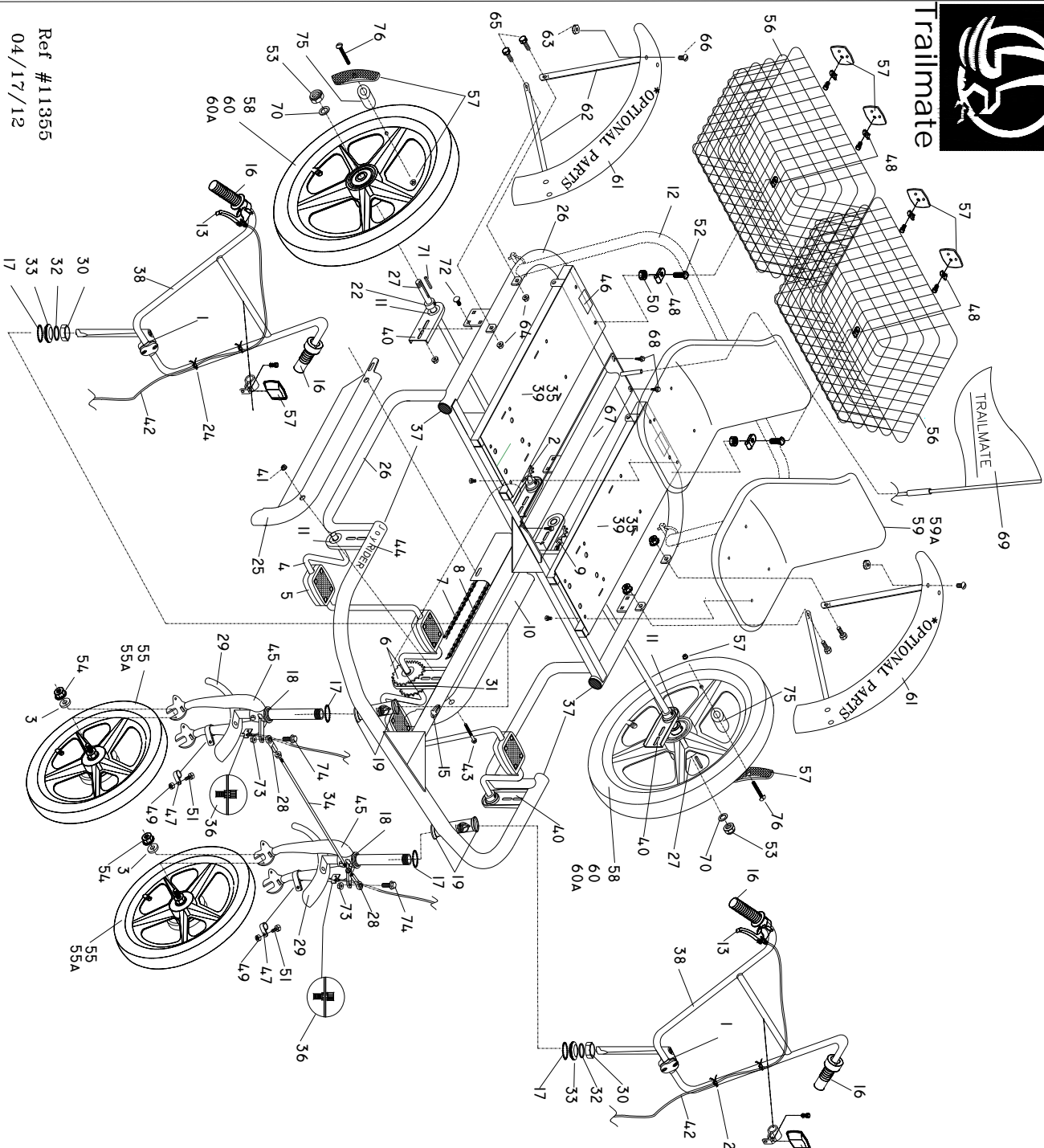

Ref #11355  
 04/17/12

## DOUBLE JOY RIDER PART LIST

ITEM NO.	PART NO.	DESCRIPTION	QTY.	ITEM NO.	PART NO.	DESCRIPTION	QTY.
1	20339	STEM TWO BOLT	2	41	11061	NUT 1/4-20 NYLON INSERT	1
2	11949	FREEWHEEL 22T & ADAPTER ASSY	1	42	17778	BRAKE CABLE 46.5 X 55.5	2
3	12301	WASHER 3/8 FLAT SAE	5	43	11361	SCREW 1/4-20X3-1/2 HHCS	1
4	18287	CRANK JOY RIDER/DJ PLATED	2	44	18335	DECAL JOY RIDER/DOUBLE JOY	2
5	19181	PEDAL HALF JOY RIDER	8	45	20448	FORK 12" DJ	2
6	19361	SPROCKET 32T W/ ADAPTER	2	46	19325	DECAL "DO NOT STAND ON CYCLE"	2
7	19391	CHAIN/CL JR/DJ 161 P FW	1	47	12279	CLAMP (BRAKE STRAP)	2
8	20413	CHAIN/CL DJ 133 P LONG CB	1	48	12069	BASKET HOLD DOWN	12
9	20412	CHAIN/CL DJ 49 P SHORT CB	1	49	12170	NUT 10-32/STAR	3
10	13860	CHAINGUARD D/JOY ASSY LEFT	1	50	12172	NUT 1/4-20 FLANGED	8
11	11642	BEARING AXLE ASF107.5	8	51	12193	SCREW 10-32X1 PAN M/S	2
12*	20404	DOUBLE JR SPOILER ASSY	1	52	16699	SCREW 1/4-20X5/8 FLANGE HD	8
13	11654	BRAKE LOCKING LEVER	2	53	19720	NUT 5/8 - 18 NYLON INSERT	2
14	11667	HUB CB TRIKE W/22T WELD SPKT	1	54	19002	NUT 3/8-24 FLANGED	4
15	11718	DECAL TM HEAD	1	55	11078	WHL 12" WHT W/TIRE,TUBE,BRAKE	2
16	11801	GRIP BLACK DC 7/8-1 ONLY	4	55A	20436	WHL 12" BLK W/TIRE,TUBE,BRAKE	2
17	11821	HEAD BEARING 3/16 X 15 B	4	56	11639	BASKET COATED TRIKE	2
18	11827	HEAD LWR FORK STATIONARY CONE	2	57	20320	REFLECTOR KIT DOUBLE JOY	2
19	11830	HEAD CUPS	4	58	19590	TIRE 24 X 2.125 BSW/TUBE K52A	2
20	18909	3SPCB/5SPD FWL - 21T SPROCKET	1	59	18206	SEAT JOY RIDER/DJ WD140LS710	2
21	11952	SPROCKET 22T SOLID W/ADAPTER	1	59A	11900	SEAT REGAL TRACTOR BLACK-REG	2
22	12241	SET COLLAR 5/8"	9	60	18239	WHL 24" MAG WHT TRIKE REAR	2
23	12246	KEY SQUARE 3/16X5/8	4	60A	20374	WHL 24" MAG BLK TRIKE REAR	2
24	12269	TIE CABLE 8 X .18	4	61*	11748	FENDER 24" MWT TRIKE REAR	2
25	19723	CHAINGUARD D/JOY ASSY RIGHT	1	62*	18306	BRACE REAR FENDER JR	4
26	20415	FRAME DOUBLE JOY	1	63*	12170	NUT 10-32/STAR	8
27	20016	AXLE DOUBLE JOY REAR W/THRD	2	64*	12175	NUT 5/16-18 FLANGED	4
28	13900	BALL JOINT ROD END DBL JOY	2	65*	12208	SCREW 5/16-18X3/4 HHCS	4
29	20181	FENDER 12" FRT JR/JUNR/DBL	2	66*	20281	SCREW 10-32 X 3/8 PAN M/S	8
30	11824	HEAD LOCK NUT	2	67	19868	CHAINGUARD D/JOY ASSY REAR	1
31	16353	SPACER PLATE BEARING HGR DJ	1	68	12188	SCREW 10-32X3/8 SLTD HWH T/F/S	4
32	11825	HEAD KEY WASHER	2	69	12102	FLAG SAFETY W/POLE W/O BRKT	1
33	11829	HEAD ADJUSTING CONE	2	70	12240	WASHER SPACER 1X41/64X.062	7
34	20394	TIE ROD DOUBLE JOY	1	71	20012	KEY SQ 3/16 X 1-1/4	2
35	20403	BASE JR/DJ SEAT SLIDE 14" ASSY	2	72	12215	SCREW 5/16-18X3/4 CARRIAGE	4
36	17851	BAND BRAKE BARREL & NUT ADJ	2	73	12178	NUT 3/8-16 FLANGED	2
37	18196	PLUG TUBE OD 1-1/2" VVRT12P018	4	74	12220	SCREW 3/8-16X1 3/4 HHCS	2
38	20419	HANDLEBAR DOUBLE JOY	2	75	12239	SPACER 1/2	2
39	20401	BASE JR/DJ SEAT SLIDE 24" ASSY	2	76	12195	SCREW 10-32X1-1/2 RHMS	2
40	18220	AXLE BEARING HLD RR JR/JUNR/DJ	5				

\*OPTIONAL PARTS ONLY

4/17/2012

## TOOLS REQUIRED

3/8" Wrench  
1/2" Wrench  
9/16" Wrench

5/32" Allen wrench  
Common Screwdriver  
Phillips Screwdriver

1/2" Socket Wrench  
Adjustable Wrench  
15/16" Wrench

Hammer  
Air Pump  
Pliers

### 1. Preparation

Remove all parts from the frame and wheel cartons. Inflate (or have inflated) tires (55 and 58) to pressure recommended on sidewalls.

Make sure tires properly seated on the rims.

### 2. Rear Wheels

Lift up the rear of the frame assembly (26) and slide the rear wheels (60) onto the axles shaft.

**Note:** Wheel hub faces in.

Align wheel-axle keyways and tap 1-1/4" key square, (71), into keyway. Install washer (70), and secure the wheels on axle with 5/8" nylon lock nut (53).

**Important:** Make certain the axle thread fully engages the nylon locking portion of nut.

### 3. Handlebar Assembly

Loosen stem bolt and insert handlebars (38) into fork head tube. Line-up handlebars with wheel and tighten stem bolt.

### 4. Front Wheels:

Place front wheels (55) and brake assembly between the fork with the axle bolts fully into the slots on the end of the fork. Secure with washers (3) and nuts (54). The brake arm must be on the left side and in front of the fork blade.

### 5. Hand Brake

Loosen the lock nut on the brake cable bracket (at the front wheels). Push the brake cable bracket upward as much as you can while pulling as much cable as possible through the hole in the bolt. Be sure the brake cable is seated properly in the brake lever (13) and that the adjustable "barrel nut" (36) at the fork is protruding below the fork plate as far as possible. Secure the lock nut on the brake bracket to hold the cable in place. **NOTE:** The hand brake may require further adjusting before riding.

### 6. Seat

Position the seat (59) over the mounting holes in the base seat/basket (39). Insert screw into bottom of the seat and secure seat.

### 7. Basket

Position the basket (56) onto seat/basket base. Place the four basket brackets (48) over the basket wires and secure with the bolt (52) and flanged nut (50).

### 8. Reflectors

Install the red reflectors on the back of the basket. Insert the screw provided with the reflector on the basket so the clip will capture the corner of the vertical and horizontal wires and tighten the screw. Repeat for the other side. The basket reflectors should be about one foot apart. Install clean reflector on each handle cross bar. Slide plastic holder on handle cross bar. Tighten with the screwdriver and install reflector. On plastic MAG wheels install reflectors on tabs using screw and nut. On MAG wheels without tabs, use spacer (75) behind reflector with longer screws (76).

### 9. Final Check

Install safety flag in holder. Review the instructions again and check connecting bolts and screws for tightness, and readjusting the seat and handlebar as necessary.

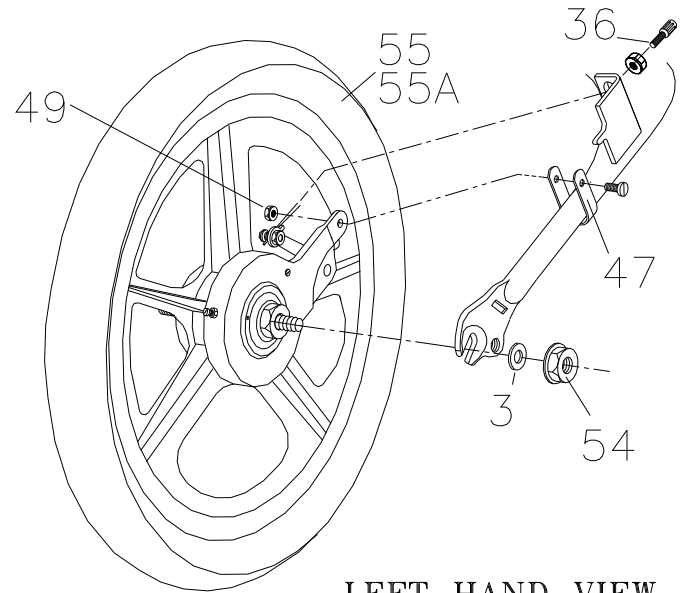

LEFT HAND VIEW  
FRONT WHEEL ASSY

Basket Reflector Installation  
To eliminate rattling of reflector,  
install as indicated below.

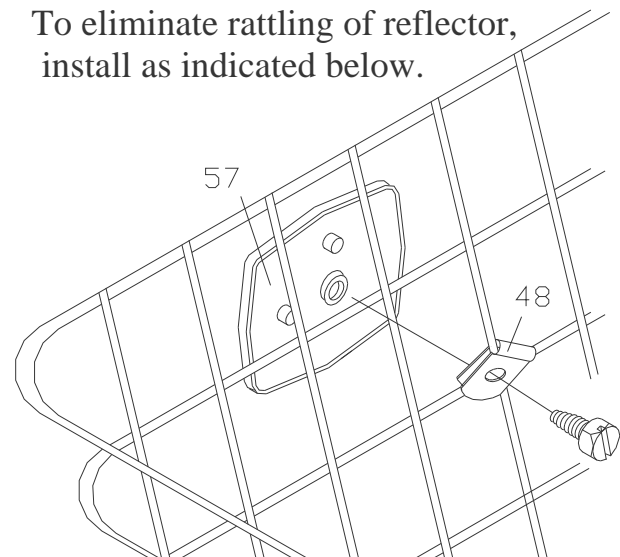

---

## REGULAR MAINTENANCE: Bi-Monthly

1. Keep all painted parts cleaned and waxed for a long-lasting luster.
2. Lubricate the following:
  - Axle shafts
  - Chain-rotate pedal crank and spray freely with a good quality spray lubricant, wipe off any excess.
3. When storing over prolonged periods, turn upside down to prevent flats from occurring on the tires. If storing outside, cover to protect finish and moving parts.

## PREVENTIVE MAINTENANCE: Every Six Months

These are services that should be performed by your local bicycle shop. A fee may be charged.

1. Check tires for wear, rim cuts and valve core alignment (usually caused by improper air pressure).
2. Check wheels for cracks and alignment.
3. Check brakes for proper operation.
4. Check and repack all bearings and adjust all cones.
5. Check for worn bearings, cones and cups.
6. Check chain for proper tension and clean as needed.
7. Check for loose bolts and nuts.

Attention: While your unit is new, some noises may occur during the break-in period. Should they continue for more than 30 days, see local bike shop.

## INSPECTION

Check the following, as it applies to your cycle, on a regular basis:

1. Wheels: Check wheels for alignment.
2. Pedals: Inspect pedals and make sure pedals are tightly attached to crank.
3. Handle grips: Replace worn or loose grips.
4. Chain: Check for proper tightness. Replace damaged chain immediately.
5. Seat: Adjust seat for ride comfort and safety.
6. Tires: Keep tires inflated to the recommended tire pressure, as indicated on the tire's sidewall.
7. Frame: Replace damaged frame immediately.

## Double Joy rider

**This is a recreational unit, not designed for excessive speed or misuse.**

**Careless operation may cause rider to lose control and result in serious injury.**

**Do not brake or turn at high speeds; this may cause cycle roll-over and rider injury.**

**Things to know before riding your cycle:**

1. Know your local bicycle laws and wear a helmet.
2. Do not exceed the recommended weight limit of 250 lbs. on one seat 350 total capacity.
3. Do not stand on unit.
4. Wear light-colored clothing and protective gear.
5. Do not ride at night.



**Trailmate**

1851 67<sup>th</sup> AVE East  
Sarasota, FL 34243

Tel: (941) 755-5511

Fax: (941) 758-5141

Visit us @ [www.trailmate.com](http://www.trailmate.com)

**For service or to order  
replacement parts  
please contact your  
local Trailmate dealer.**

# DOUBLE JOY RIDER

This is a recreational unit, not designed for excessive speeds or misuse.

Do not brake or turn at high speeds. This may cause cycle to roll over. Careless operation may cause rider to lose control and result in serious injury.

## **Things to know before riding your cycle:**

1. Know your local bicycle laws and wear a helmet.
2. Do not exceed the recommended weight limit of 250 lbs per seat or 350lbs total
3. No more than one rider at one time.
4. Do not stand on unit.
5. Be sure to install safety flags.
6. Wear light-colored clothing and protective gear.
7. Do not ride at night.
8. Children must be supervised by an adult at all times.

### **Trailmate Limited Warranty**

Trailmate, Inc., guarantees each cycle product against all defects in materials and workmanship for a period of 90 days from date of purchase. Tires and tubes are not covered by this guarantee.

During this period, any part that is judged by the makers to be defective will be replaced free of charge. Any failure resulting from accident, abuse, neglect, normal wear, or improper assembly or maintenance by the owner is not covered.

Trailmate, Inc., further authorizes a lifetime frame guarantee and will replace any frame, at no cost to the buyer, providing that item has not been used for rental use and that:

- 1) The item has not been altered, repaired, or modified in any way.
- 2) The item has not been subject to misuse, negligence, and/or an accident.
- 3) Original ownership is established.

Any parts under this guarantee on which claims are entered shall be returned for inspection with transportation charges prepaid by the claimant. Replacement parts will be shipped F.O.B. factory.

There are no warranties or guarantee, expressed or implied, written or oral, which extend beyond the description on the face hereof.